



# Tamar Way

Tottenham Hale, London

## Information

Tor Coating system used:



Category

**Balcony**

Sector

**Communal**

Guarantee

**15 years**

Coverage area

**600m<sup>2</sup>**

## Background

Tamar Way is a housing estate in the borough of Harringey, north London. The estate has many open air walkways that over time have been degraded by the elements and regular use by the residents.

1

### Free Site Survey

Before the correct coating system could be specified, Tor Coatings carried out a comprehensive free survey of the site to ensure every aspect of the project was clearly understood and all defects were documented thoroughly. The communal walkways at Tamar Way required a warranted waterproofing solution with an anti-slip finish to ensure the safety and security of residents, while causing as little disruption as possible during installation.

2

### Product Specification

The Elastadeck™ system by Tor Coatings was recommended and a specification was prepared and tendered. Elastadeck's low odour, fast-cure formula provides an effective waterproofing system combined with a highly durable, slip-resistant finish. This purpose-built product allows quick and efficient installation on site, requiring less coats and less disruption to the residents at Tamar Way.

3

### Installation

The project was undertaken by Tor with our Tor Partner contractor, Fairfield Contract, to deliver the above quickly and efficiently.

4

### Continued Support

With a watertight guarantee and a comprehensive range of no-quibble warranties, the client was safe in the knowledge that their building will be protected for years to come. The Elastadeck system has a guaranteed life of 15 years to first major maintenance but we can also demonstrate that using this aggregate has delivered almost 20 years of continuous use on balcony sites across the UK.

For every building surface inside and out, we've got it covered.



**During**



**After**

## Elastadeck™

### Key benefits:

- 2 Coat system\*
- Fast cure layers (60-90 minutes 'walk on' time)
- Low odour system
- Fully reinforced, seamless waterproofing system
- Slip-resistant
- Highly durable 15 year system
- Full range of low odour Primers
- Smooth fast cure edge detail system



Fast curing with less than 90mins 'walk on time' per coat.



Two coat system for quicker installation and less disturbance.



Piece of mind 15 year watertight guarantee.



Low odour formula for less disruption during application.

### Typical build-up of the Elastadeck system

- A** Prepared existing substrate
  - B** Optional Primer\*
  - C** Elastadeck™ Mat chopped GRP reinforcement embedded in Elastadeck™ Walkway Gritcoat
  - D** 30 mesh aluminium oxide grit
  - E** Elastadeck™ Walkway Topcoat
  - F** Elastadeck™ Edge Detail Basecoat
  - G** Elastadeck™ Edge Detail Topcoat
- \*Primer only needed on porous or metallic surfaces

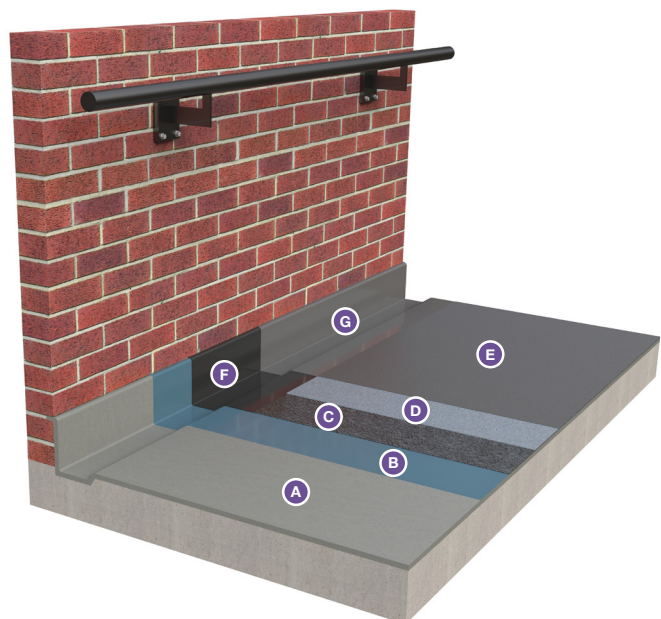

For more information and further case studies please visit [www.tor-coatings.com](http://www.tor-coatings.com)  
To speak to a member of the sales team call 0191 4106611 or email [marketing@tor-coatings.com](mailto:marketing@tor-coatings.com)